

"BULLET RESISTANT" EXTRA HEAVY WALL FIBERGLASS CONDUIT

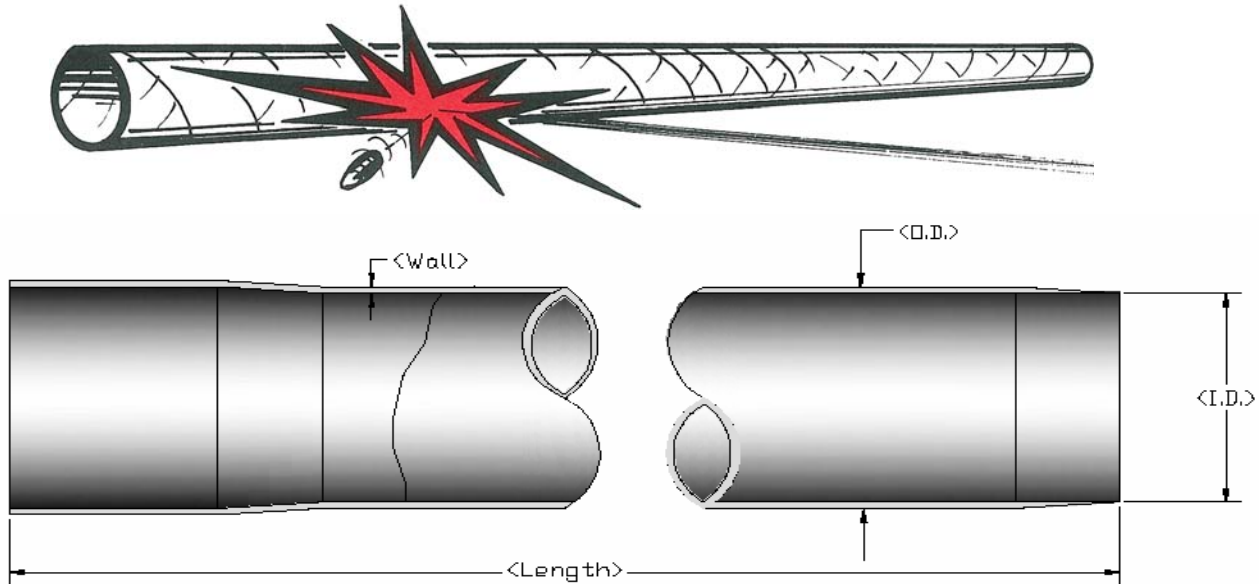

SIZE	PART NUMBER	I.D.	O.D.	WALL	F	LBS/FT
2" XHW	20B-XW-AG-20-1	2.00 (57)	2.48 (63)	.250 (6)	240" (6.1)	1.25
3" XHW	30B-XW-AG-20-1	3.00 (76)	3.48 (88)	.250 (6)	240" (6.1)	1.83
4" XHW	40B-XW-AG-20-1	4.00 (101)	4.48 (114)	.250 (6)	240" (6.1)	2.60
5" XHW	50B-XW-AG-20-1	5.00 (127)	5.48 (139)	.250 (6)	240" (6.1)	3.47
6" XHW	60B-XW-AG-20-1	6.00 (152)	6.48 (165)	.250 (6)	240" (6.1)	3.83
8" XHW	80A-XW-AG-20-1	8.40 (152)	8.90 (226)	.250 (6)	240" (6.1)	4.90
10" XHW	10B-XW-AG-20-1	10.00 (152)	10.50 (267)	.250 (6)	240" (6.1)	5.90
12" XHW	12B-XW-AG-20-1	12.00 (152)	12.50 (318)	.250 (6)	240" (6.1)	6.90

FOR 10' LENGTHS, CHANGE (20) IN CONDUIT PART NUMBER TO (10)

CONDUIT COLOR CHART—LAST NUMBER IN PART # DENOTES COLOR. CONTACT UFA FOR SPECIAL COLOR PRICING.

1	2	3
BLACK	GRAY	CONCRETE

United Fiberglass Above Ground "Bullet Resistant" Products meet and exceed the latest requirements of UL 1684 A

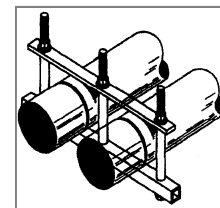

Conduit, supports enclosures are designed to work together as a system. For optimal performance, use only United Fiberglass of America products when installing conduit systems on bridge structures.



SLEEVE COUPLING

SLEEVE COUPLINGS CAN BE USED TO SLEEVE THROUGH A BRIDGE ABUTMENT WALL, OR HANGER SUPPORT WINDOW TO PROTECT CONDUIT. MAY ALSO BE USED TO REPAIR BROKEN DUCT. SLEEVES ARE NOT RECOMMENDED FOR JOINING TWO MALE ENDS OF CONDUIT.

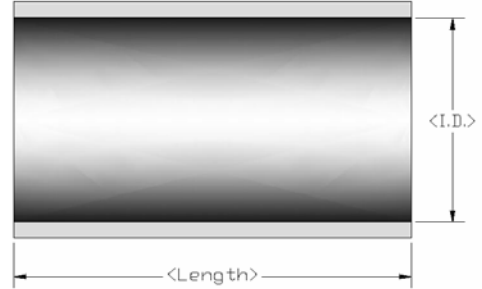

XHW Part Number

DIAMETER	AG PART NO.	A (ID)	C (Length)
2" XW	20B-SW-AG-470-1	2.50	7"
3" XW	30B-XW-AG-470-1	3.50"	7"
4" XW	40B-XW-AG-470-1	4.50	7"
5" XW	50B-XW-AG-470-1	5.50"	7"
6" XW	60B-XW-AG-470-1	6.50"	7"
8" XW	80A-XW-AG-470-1	8.92"	7"
10" XW	10B-XW-AG-470-1	10.50"	7"
12" XW	12B-XW-AG-470-1	12.50"	7"



STOP COUPLING

STOP COUPLINGS, OR DOUBLE BELL COUPLINGS ARE USED TO JOIN MALE ENDS OF CONDUIT AFTER A FIELD CUT HAS BEEN MADE.

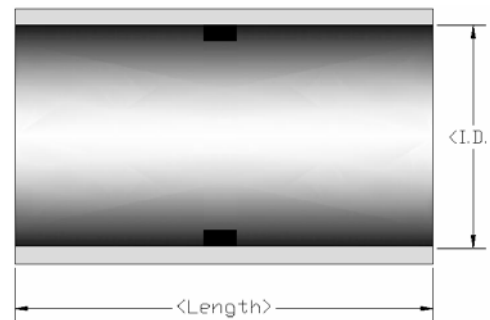

XHW Part Number

DIAMETER	AG PART NO.	A (ID)	C (Length)
2" XW	20B-XW-AG-510-1	2.50	7"
3" XW	30B-XW-AG-510-1	3.50"	7"
4" XW	40B-XW-AG-510-1	4.50	7"
5" XW	50B-XW-AG-510-1	5.50"	7"
6" XW	60B-XW-AG-510-1	6.50"	7"
8" XW	80A-XW-AG-510-1	8.92"	7"
10" XW	10B-XW-AG-510-1	10.50"	7"
12" XW	12B-XW-AG-510-1	12.50"	7"



MALE THREADED ADAPTOR

MALE ADAPTORS CAN BE USED TO JOIN TO THE FEMALE END OF RIGID STEEL PIPE, OR TO TERMINATE INTO BOXES WITH FEMALE THREADS.

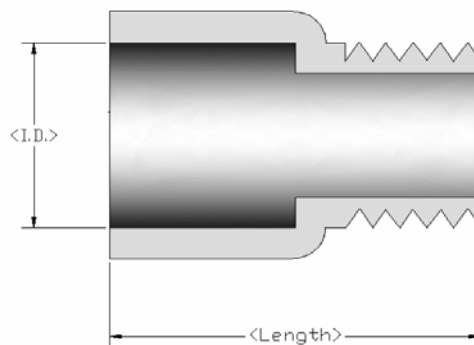

XHW Part Number

DIAMETER	AG PART NO.	A (ID)	C (Length)
2" XW	20B-SW-AG-570-1	2.50	7"
3" XW	30B-XW-AG-570-1	3.50"	7"
4" XW	40B-XW-AG-570-1	4.50	7"
5" XW	50B-XW-AG-570-1	5.50"	7"
6" XW	60B-XW-AG-570-1	6.50"	7"
8" XW	80A-XW-AG-570-1	8.92"	7"
10" XW	10B-XW-AG-570-1	10.50"	7"
12" XW	12B-XW-AG-570-1	12.50"	7"



FEMALE THREADED ADAPTOR

FEMALE ADAPTORS ARE USED TO JOIN FIBERGLASS CONDUIT TO RIGID STEEL CONDUIT. THIS CONNECTION IS MOST COMMONLY MADE AT BRIDGE ABUTMENTS

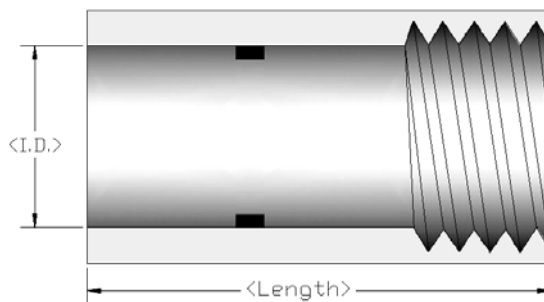

XHW Part Number

DIAMETER	AG PART NO.	A (ID)	C (Length)
2" XW	20B-XW-AG-580-1	2.50	7"
3" XW	30B-XW-AG-580-1	3.50"	7"
4" XW	40B-XW-AG-580-1	4.50	7"
5" XW	50B-XW-AG-580-1	5.50"	7"
6" XW	60B-XW-AG-580-1	6.50"	7"
8" XW	80A-XW-AG-580-1	8.92"	7"
10" XW	10B-XW-AG-580-1	10.50"	7"
12" XW	12B-XW-AG-580-1	12.50"	7"



MALE BOX CONNECTOR

MALE BOX CONNECTORS TERMINATE FIBERGLASS CONDUIT INTO A BOX. THIS CONNECTOR IS SUPPLIED WITH A LOCK RING AND OPTIONAL RUBBER SEALING RING.

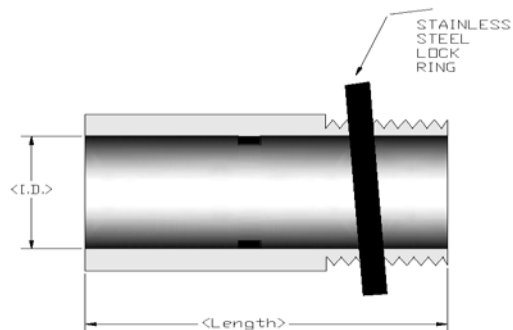

XHW Part Number

DIAMETER	AG PART NO.	A (ID)	C (Length)
2" XW	20B-SW-AG-570-1	2.50	7"
3" XW	30B-XW-AG-590-1	3.50"	7"
4" XW	40B-XW-AG-590-1	4.50	7"
5" XW	50B-XW-AG-590-1	5.50"	7"
6" XW	60B-XW-AG-590-1	6.50"	7"
8" XW	80A-XW-AG-590-1	8.92"	7"
10" XW	10B-XW-AG-590-1	10.50"	7"
12" XW	12B-XW-AG-590-1	12.50"	7"



REDUCING ADAPTOR

REDUCING ADAPTORS ARE USED TO JOIN I.D. TUBULAR FIBERGLASS TO I.P.S. FIBERGLASS OR PVC CONDUIT. REDUCING ADAPTORS ARE ALSO AVAILABLE TO JOIN DIFFERENT SIZES OF FIBERGLASS CONDUIT.

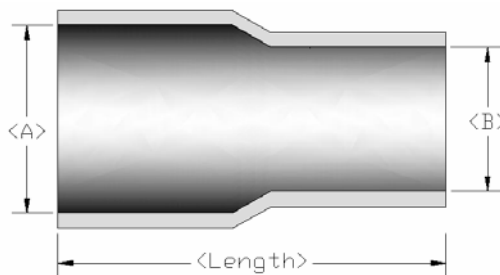

XHW Part Number

DIAMETER	AG PART NO.	A (ID)	C (Length)
2" XW	20B-XW-AG-520-1	2.50	7"
3" XW	30B-XW-AG-520-1	3.50"	7"
4" XW	40B-XW-AG-520-1	4.50	7"
5" XW	50B-XW-AG-520-1	5.50"	7"
6" XW	60B-XW-AG-520-1	6.50"	7"
8" XW	80A-XW-AG-520-1	8.92"	7"
10" XW	10B-XW-AG-520-1	10.50"	7"
12" XW	12B-XW-AG-520-1	12.50"	7"



WOBBLE COUPLINGS

PROVIDE FOR SLIGHT HORIZONTAL AND VERTICAL ADJUSTMENTS IN EXPOSED CONDUIT RUNS

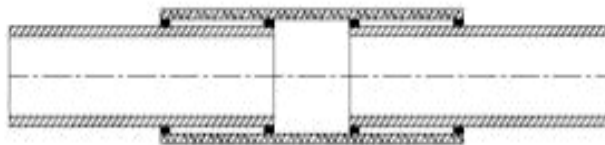

XHW Part Number

DIAMETER	AG PART NO.	(ID)	(Length)
2" XW	20B-SW-AG-470-1	Contact	UFA
3" XW	30B-XW-AG-470-1	"	"
4" XW	40B-XW-AG-470-1	"	"
5" XW	50B-XW-AG-470-1	"	"
6" XW	60B-XW-AG-470-1	"	"
8" XW	80A-XW-AG-470-1	"	"
10" XW	10B-XW-AG-470-1	"	"
12" XW	12B-XW-AG-470-1	"	"



EXPANSION/DEFLECTION JOINTS

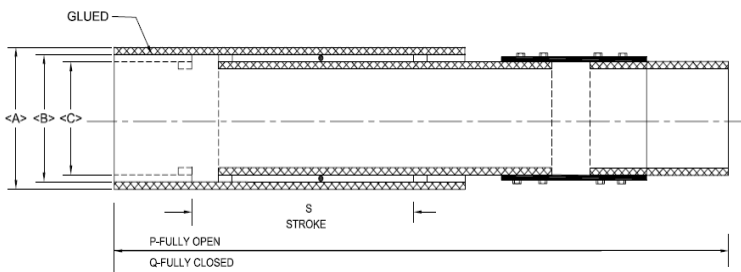

XHW Part Number

DIAMETER	AG PART NO.	(ID)	Length/ Open	Stroke
2" XW	20B-SW-AG-460-1	Contact	45"	6"
3" XW	30B-XW-AG-460-1	"	45"	6"
4" XW	40B-XW-AG-460-1	"	45"	6"
5" XW	50B-XW-AG-460-1	"	45"	6"
6" XW	60B-XW-AG-460-1	"	45"	6"
8" XW	80A-XW-AG-460-1	"	45"	6"
10" XW	10B-XW-AG-460-1	"	45"	6"
12" XW	12B-XW-AG-460-1	"	45"	6"



EXPANSION JOINT

EXPANSION JOINTS ARE USED TO ACCOMMODATE CHANGES IN CONDUIT LENGTH DUE TO TEMPERATURE FLUCTUATIONS.

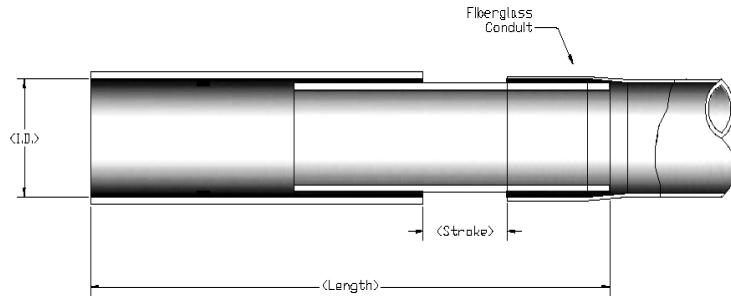

XHW Part Number

DIAMETER	AG PART NO.	A (ID)	LENGTH	STROKE
2" XW	20B-SW-AG-400-1	2.50"	23"	7"
3" XW	30B-XW-AG-400-1	3.50"	23"	7"
4" XW	40B-XW-AG-400-1	4.50"	23"	7"
5" XW	50B-XW-AG-400-1	5.50"	23"	7"
6" MW	60B-XW-AG-400-1	6.60"	23"	7"
8" XW	80B-XW-AG-400-1	8.50"	23"	7"
10" XW	10B-XW-AG-400-1	10.50"	23"	7"
12" XW	12B-XW-AG-400-1	12.50"	23"	7"

EXPANSION JOINTS CAN BE MANUFACTURED WITH A LONGER STROKE. PLEASE CONSULT UFA FOR SPECIAL APPLICATIONS.



BACK-TO-BACK EXPANSION JOINT

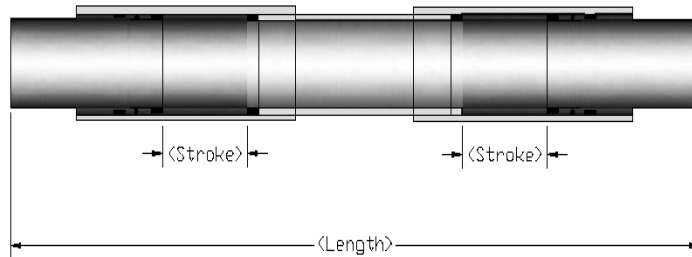

XHW Part Number

DIAMETER	AG PART NO.	A (ID)	LENGTH	STROKE
2" XW	20B-SW-AG-420-1	2.50"	23"	7"
3" XW	30B-XW-AG-420-1	3.50"	23"	7"
4" XW	40B-XW-AG-420-1	4.50"	23"	7"
5" XW	50B-XW-AG-420-1	5.50"	23"	7"
6" MW	60B-XW-AG-420-1	6.60"	23"	7"
8" XW	80B-XW-AG-420-1	8.50"	23"	7"
10" XW	10B-XW-AG-420-1	10.50"	23"	7"
12" XW	12B-XW-AG-420-1	12.50"	23"	7"



O-RING EXPANSION JOINT

EXPANSION JOINTS ARE USED TO ACCOMMODATE CHANGES IN CONDUIT LENGTH DUE TO TEMPERATURE FLUCTUATIONS.

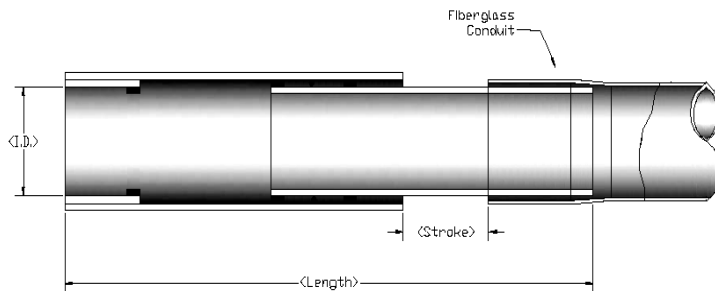

XHW Part Number

DIAMETER	AG PART NO.	A (ID)	LENGTH	STROKE
2" XW	20B-SW-AG-410-1	2.50"	23"	7"
3" XW	30B-XW-AG-410-1	3.50"	23"	7"
4" XW	40B-XW-AG-410-1	4.50"	23"	7"
5" XW	50B-XW-AG-410-1	5.50"	23"	7"
6" MW	60B-XW-AG-410-1	6.60"	23"	7"
8" XW	80B-XW-AG-410-1	8.50"	23"	7"
10" XW	10B-XW-AG-410-1	10.50"	23"	7"
12" XW	12B-XW-AG-410-1	12.50"	23"	7"

EXPANSION JOINTS CAN BE MANUFACTURED WITH A LONGER STROKE. PLEASE CONSULT UFA FOR SPECIAL APPLICATIONS.



BACK-TO-BACK O-RING EXPANSION JOINT

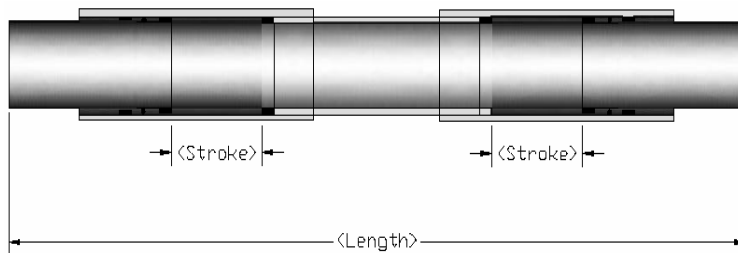

XHW Part Number

DIAMETER	AG PART NO.	A (ID)	LENGTH	STROKE
2" XW	20B-SW-AG-430-1	2.50"	53"	7"
3" XW	30B-XW-AG-430-1	3.50"	53"	7"
4" XW	40B-XW-AG-430-1	4.50"	53"	7"
5" XW	50B-XW-AG-430-1	5.50"	53"	7"
6" MW	60B-XW-AG-430-1	6.60"	53"	7"
8" XW	80B-XW-AG-430-1	8.50"	53"	7"
10" XW	10B-XW-AG-430-1	10.50"	53"	7"
12" XW	12B-XW-AG-430-1	12.50"	53"	7"



SPLIT STOP RINGS

SPLIT STOP RINGS CREATE A FIXED POINT IN BETWEEN TWO EXPANSION JOINTS. TWO PAIRS OF SPLIT STOP RINGS ARE REQUIRED FOR EACH EXPANSION JOINT USED. THEY ARE BONDED WITH ADHESIVE ON EACH SIDE OF AN ANCHOR POINT HANGER WHICH IS PLACED MID-POINT BETWEEN TWO EXPANSION JOINTS.

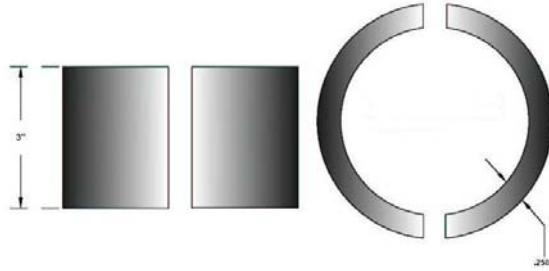

XHW Part Number

DIAMETER	AG PART NO.	BG PART NO.	WALL	LENGTH
2" XW	20B-SW-AG-440-1	N/A	.250	3"
3" XW	30B-XW-AG-440-1	N/A	.250	3"
4" XW	40B-XW-AG-440-1	N/A	.250	3"
5" XW	50B-XW-AG-440-1	N/A	.250	3"
6" XW	60B-XW-AG-440-1	N/A	.250	3"
8" XW	80A-XW-AG-440-1	N/A	.250	3"
10" XW	10B-XW-AG-440-1	N/A	.250	3"
12" XW	12B-XW-AG-440-1	N/A	.250	3"



SPLIT STOP RINGS

HEAVY WALL STOP RINGS ARE USED WHERE THE HANGER SUPPORT WINDOW IS DESIGNED LARGE ENOUGH FOR THE BELL ENDS OF THE CONDUIT TO PASS THROUGH. CONTACT UNITED FIBERGLASS FOR SPECIAL WALL THICKNESSES.

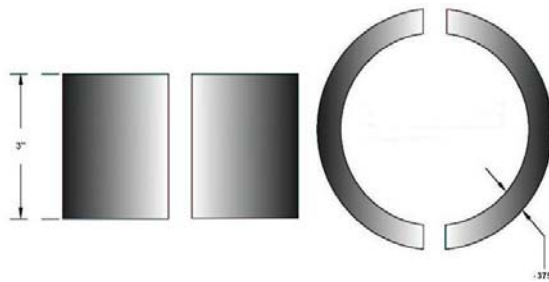

XHW Part Number

DIAMETER	AG PART NO.	BG PART NO.	WALL	LENGTH
2" XW	20B-SW-AG-450-1	N/A	.375	3"
3" XW	30B-XW-AG-450-1	N/A	.375	3"
4" XW	40B-XW-AG-450-1	N/A	.375	3"
5" XW	50B-XW-AG-450-1	N/A	.375	3"
6" XW	60B-XW-AG-450-1	N/A	.375	3"
8" XW	80A-XW-AG-450-1	N/A	.375	3"
10" XW	10B-XW-AG-450-1	N/A	.375	3"
12" XW	12B-XW-AG-450-1	N/A	.375	3"



11.25°

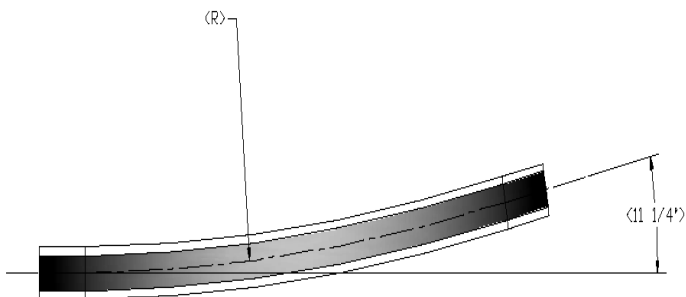

TANGENT = 4"

DIAMETER	36" RAD	48" RAD	60" RAD
2" XHW	20B-XW-AG-1136-A-1	20B-XW-AG-1148-A-1	20A-XW-AG-1160-A-1
3" XHW	30B-XW-AG-1136-A-1	30B-XW-AG-1148-A-1	30A-XW-AG-1160-A-1
4" XHW	40B-XW-AG-1136-A-1	40B-XW-AG-1148-A-1	40A-XW-AG-1160-A-1
5" XHW	n/a	50B-XW-AG-1148-A-1	50A-XW-AG-1160-A-1
6" XHW	n/a	60B-XW-AG-1148-A-1	60A-XW-AG-1160-A-1



22.5°

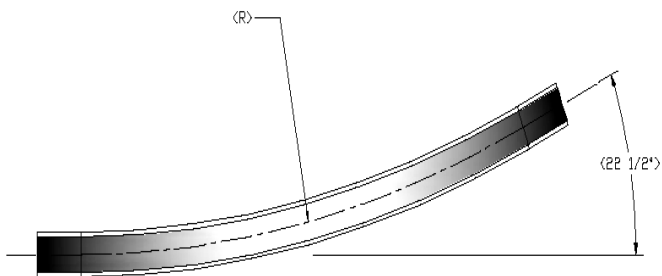

TANGENT = 4"

DIAMETER	36" RAD	48" RAD	60" RAD
2" XHW	20B-XW-BG-2236-A-1	20B-XW-BG-2248-A-1	20A-XW-BG-2260-A-1
3" XHW	30B-XW-BG-2236-A-1	30B-XW-BG-2248-A-1	30A-XW-BG-2260-A-1
4" XHW	40B-XW-BG-2236-A-1	40B-XW-BG-2248-A-1	40A-XW-BG-2260-A-1
5" XHW	n/a	50B-XW-BG-2248-A-1	50A-XW-BG-2260-A-1
6" XHW	n/a	60B-XW-BG-2248-A-1	60A-XW-BG-2260-A-1



30°

DIAMETER	36" RAD	48" RAD	60" RAD
2" XHW	20B-XW-AG-3036-A-1	20B-XW-AG-3048-A-1	20A-XW-AG-3060-A-1
3" XHW	30B-XW-AG-3036-A-1	30B-XW-AG-3048-A-1	30A-XW-AG-3060-A-1
4" XHW	40B-XW-AG-3036-A-1	40B-XW-AG-3048-A-1	40A-XW-AG-3060-A-1
5" XHW	n/a	50B-XW-AG-3048-A-1	50A-XW-AG-3060-A-1
6" XHW	n/a	60B-XW-AG-3048-A-1	60A-XW-AG-3060-A-1

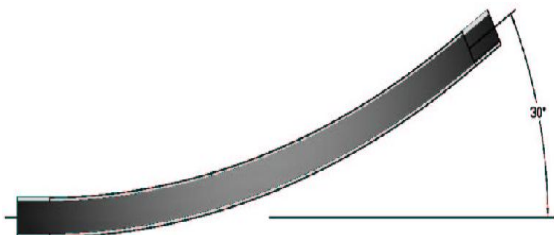

TANGENT = 4"



45°

DIAMETER	36" RAD	48" RAD	60" RAD
2" XHW	20B-XW-AG-4536-A-1	20B-XW-AG-4548-A-1	20A-XW-AG-4560-A-1
3" XHW	30B-XW-AG-4536-A-1	30B-XW-AG-4548-A-1	30A-XW-AG-4560-A-1
4" XHW	40B-XW-AG-4536-A-1	40B-XW-AG-4548-A-1	40A-XW-AG-4560-A-1
5" XHW	n/a	50B-XW-AG-4548-A-1	50A-XW-AG-4560-A-1
6" XHW	n/a	60B-XW-AG-4548-A-1	60A-XW-AG-4560-A-1

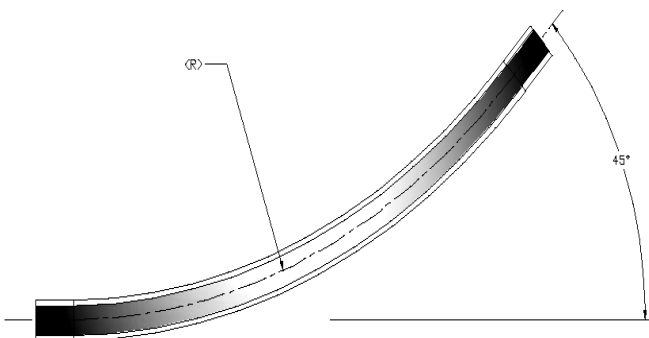

TANGENT = 4"



90°

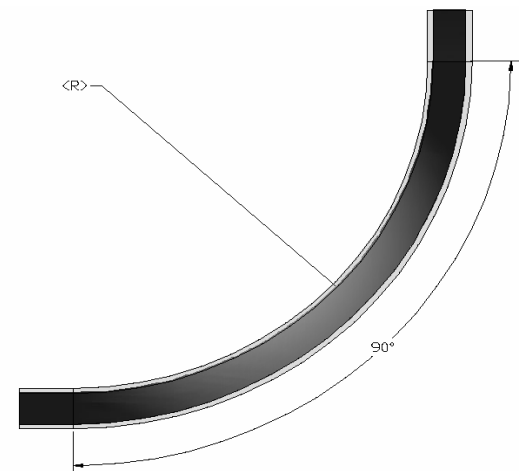

TANGENT = 4"

DIAMETER	36" RAD	48" RAD	60" RAD
2" XHW	20B-XW-AG-9036-A-1	20B-XW-AG-9048-A-1	20A-XW-AG-9060-A-1
3" XHW	30B-XW-AG-9036-A-1	30B-XW-AG-9048-A-1	30A-XW-AG-9060-A-1
4" XHW	40B-XW-AG-9036-A-1	40B-XW-AG-9048-A-1	40A-XW-AG-9060-A-1
5" XHW	n/a	50B-XW-AG-9048-A-1	50A-XW-AG-9060-A-1
6" XHW	n/a	60B-XW-AG-9048-A-1	60A-XW-AG-9060-A-1



POLE RISERS

RISERS PROVIDE CABLE PROTECTION ON UTILITY POLES AND BRIDGE PIERS

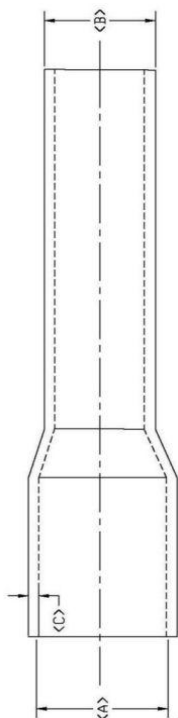

DIAMETER	10' LENGTH	20' LENGTH	(A)	(B)	(C)
2" XW	20A-XW-AG-710-1	20A-XW-AG-720-1	2.54	2.50	.250
3" XW	30A-XW-AG-710-1	30A-XW-AG-720-1	3.54"	3.50	.250
4" XW	40A-XW-AG-710-1	40A-XW-AG-720-1	4.54	4.50	.250
5" XW	50A-XW-AG-710-1	50A-XW-AG-720-1	5.54"	5.50	.250
6" XW	60A-XW-AG-710-1	60A-XW-AG-720-1	6.54"	6.50	.250



USE UNITED FIBERGLASS COMPOSITE STRAPS AND STRUT WHEN AFIXING RISERS TO POLES OR PIERS